



Date: 26-July-2024
Project No: 230790
Project: MIXED USE DEVELOPMENT
GOOGONG
Issued By: XX

Reason	Method	Type
I Information	E eMail	D DWG
P Preliminary	H Hand	P PDF
A Approval	F FTP Site	
D Detailed Design		
T Tender		
C Construction		
W Work As Executed		

Date of Issue															
24.11.23	17.06.24	18.06.24	01.07.24	03.07.24	26.07.24										

Reason	A	A	A	A	A										
Method	E	E	E	E	E										
Type	P	P	P	P	P										

Company	Name	Revision History													
DEVELOPMENT APPLICATION		1													
COUNCIL COMMENTS			2	3											
DA COUNCIL COMMENTS					4	5	6								

Miscellaneous Documents	Current	Miscellaneous Documents Revisions													

Sketches	Current	Sketch Revisions													

Drawings		Current	Date Of Drawing Revision													
GENERAL			-	-	-	-	-									
230790-DRG-CIV-0001-GN	COVER SHEET, DRAWING INDEX - AND LOCALITY	E	A	B	C	-	D	E								
230790-DRG-CIV-0002-GN	GENERAL NOTES - AND LEGEND	E	A	B	C	-	D	E								
230790-DRG-CIV-0003-GN	CONCRETE NOTES		-	-	-	-	-	-								
ALIGNMENT			-	-	-	-	-	-								
230790-DRG-CIV-0101-AL	GENERAL ARRANGEMENT - PLAN SHEET 1	F	A	B	C	D	E	F								
230790-DRG-CIV-0102-AL	GENERAL ARRANGEMENT - PLAN SHEET 2		-	-	-	-	-	-								
230790-DRG-CIV-0111-AL	ALIGNMENT - TYPICAL CROSS SECTIONS		-	-	-	-	-	-								
230790-DRG-CIV-0121-AL	ALIGNMENT - CONTROL AND GRADING PLAN	E	A	B	C	-	D	E								
230790-DRG-CIV-0131-AL	ALIGNMENT - HORIZONTAL SETOUT TABLES		-	-	-	-	-	-								
230790-DRG-CIV-0141-AL	ALIGNMENT - ROAD LONGITUDINAL SECTIONS	E	A	B	C	-	D	E								
EARTHWORKS			-	-	-	-	-	-								
230790-DRG-CIV-0201-EW	EARTHWORKS - CUT AND FILL VOLUMES PLAN		-	-	-	-	-	-								
230790-DRG-CIV-0211-EW	EARTHWORKS - LONGITUDINAL SECTIONS		-	-	-	-	-	-								
PAVEMENT			-	-	-	-	-	-								
230790-DRG-CIV-0301-PV	PAVEMENT PLAN - SHEET 1	F	A	B	C	D	E	F								
230790-DRG-CIV-0302-PV	PAVEMENT PLAN - SHEET 2		-	-	-	-	-	-								
230790-DRG-CIV-0311-PV	PAVEMENT CONCRETE JOINTING - PLAN		-	-	-	-	-	-								
230790-DRG-CIV-0321-PV	PAVEMENT DRIVEWAY JOINTING - PLAN		-	-	-	-	-	-								
230790-DRG-CIV-0331-PV	PAVEMENT DETAILS - SHEET 1		-	-	-	-	-	-								
230790-DRG-CIV-0332-PV	PAVEMENT DETAILS - SHEET 2		-	-	-	-	-	-								
STORMWATER			-	-	-	-	-	-								
230790-DRG-CIV-0400-DR	STORMWATER NOTES AND DETAILS		-	-	-	-	-	-								
230790-DRG-CIV-0401-DR	STORMWATER AND SUBSOIL DRAINAGE - PLAN S	F	A	B	C	D	E	F								
230790-DRG-CIV-0402-DR	STORMWATER AND SUBSOIL DRAINAGE - PLAN S		-	-	-	-	-	-								
230790-DRG-CIV-0411-DR	STORMWATER - STRUCTURE SETOUT SCHEDULE		-	-	-	-	-	-								
230790-DRG-CIV-0421-DR	STORMWATER - LONGITUDINAL SECTIONS	E	A	B	C	-	D	E								
230790-DRG-CIV-0431-DR	STORMWATER - DETAILS		-	-	-	-	-	-								
230790-DRG-CIV-0491-DR	WATER SENSITIVE URBAN - DESIGN PLAN		-	-	-	-	-	-								
UTILITIES			-	-	-	-	-	-								
230790-DRG-CIV-0501-UT	UTILITIES PLAN - SHEET 1	F	A	B	C	D	E	F								
230790-DRG-CIV-0502-UT	UTILITIES PLAN - SHEET 2		-	-	-	-	-	-								
230790-DRG-CIV-0511-UT	UTILITIES - DETAILS		-	-	-	-	-	-								
RETAINING WALLS			-	-	-	-	-	-								
230790-DRG-CIV-0601-RW	RETAINING WALLS - ALIGNMENT CONTROL AND F		-	-	-	-	-	-								
TRAFFIC CONTROL DEVICES			-	-	-	-	-	-								
230790-DRG-CIV-0701-TC	TCDD PLAN		-	-	-	-	-	-								
TEMPORARY TRAFFIC MANAGEME			-	-	-	-	-	-								
230790-DRG-CIV-0800-TM	COVER SHEET, DRAWING INDEX - AND LOCALITY		-	-	-	-	-	-								
230790-DRG-CIV-0801-TM	TRAFFIC MANAGEMENT PLAN		-	-	-	-	-	-								
230790-DRG-CIV-0802-TM	TRAFFIC MANAGEMENT PLAN PROJECT - OVERVI		-	-	-	-	-	-								
230790-DRG-CIV-0803-TM	TRAFFIC MANAGEMENT PLAN - RISK MATRIX		-	-	-	-	-	-								
230790-DRG-CIV-0811-TM	VEHICLE MOVEMENTS PLAN		-	-	-	-	-	-								
230790-DRG-CIV-0831-TM	TRAFFIC GUIDANCE SCHEME		-	-	-	-	-	-								
230790-DRG-CIV-0851-TM	CONSTRUCTION PARKING PLAN		-	-	-	-	-	-								
ENVIRONMENTAL MANAGEMENT			-	-	-	-	-	-								
230790-DRG-CIV-0900-EV	LANDSCAPE MANAGEMENT - NOTES AND LEGEND		-	-	-	-	-	-								
230790-DRG-CIV-0901-EV	LANDSCAPE MANAGEMENT AND - PROTECTION P	E	A	B	C	-	D	E								
230790-DRG-CIV-0910-EV	SEDIMENT EROSION CONTROL - NOTES AND LEG	E	A	B	C	-	D	E								
230790-DRG-CIV-0911-EV	SEDIMENT EROSION CONTROL - PLAN		-	-	-	-	-	-								
DEMOLITION			-	-	-	-	-	-								
230790-DRG-CIV-1101-DM	DEMOLITION - PLAN		-	-	-	-	-	-								
VEHICLE TURNING PATHS			-	-	-	-	-	-								
230790-DRG-CIV-2201-TP	VEHICLE TURNING PATHS PLAN - SHEET 1	F	A	B	C	D	E	F								
230790-DRG-CIV-2202-TP	VEHICLE TURNING PATHS PLAN - SHEET 2		A	B	C	D	E	F								
230790-DRG-CIV-2203-TP	VEHICLE TURNING PATHS PLAN - SHEET 3	D	-	-	-	B	C	D								
230790-DRG-CIV-2204-TP	VEHICLE TURNING PATHS PLAN - SHEET 4	A	-	-	-	-	-	A								
WASTE MANAGEMENT			-	-	-	-	-	-								
230790-DRG-CIV-2301-WM	WASTE MANAGEMENT PLAN	F	A	B	C	D	E	F								
230790-DRG-CIV-2302-WM	WASTE MANAGEMENT PLAN	F	A	B	C	D	E	F								
230790-DRG-CIV-2303-WM	WASTE MANAGEMENT PLAN	E	A	B	C	-	D	E								
230790-DRG-CIV-2304-WM	WASTE MANAGEMENT PLAN	B	A	-	-	-	-	B								
230790-DRG-CIV-2305-WM	WASTE MANAGEMENT PLAN	B	A	-	-	-	-	B								
230790-DRG-CIV-2331-WM	TYPICAL WASTE ENCLOSURE - DETAIL SHEET 1		-	-	-	-	-	-								
230790-DRG-CIV-2332-WM	TYPICAL WASTE ENCLOSURE - DETAIL SHEET 2		-	-	-	-	-	-								

PROPOSED MIXED USE DEVELOPMENT

LOT 642 DP 1289740
GOOGONG NSW

BASE DEVELOPMENTS

WM-2301	WASTE MANAGEMENT PLAN
WM-2302	WASTE ENCLOSURE DETAILS
WM-2303	WASTE TRANSFER STATION DETAILS

230790

CIVIL ENGINEERING

DEVELOPMENT APPLICATION



				Status				Project Name and Location						
				NOT FOR CONSTRUCTION				MIXED USE DEVELOPMENT						
E	COUNCIL COMMENTS	26.07.2024	DM	Original Size	A1	Drawn By	DM	Drafting Check	GOOGONG					
D	FOR DEVELOPMENT APPROVAL	03.07.2024	DM	Date Plotted	26-Jul-24	Designed By	LT	Design Check	Drawing Title					
C	FOR DEVELOPMENT APPROVAL	18.06.2024	DM	Coordinate System	STROMLO GRID	Approved	AM	Approved Date	COVER SHEET, DRAWING INDEX					
B	FOR DEVELOPMENT APPROVAL	17.06.2024	DM						AND LOCALITY PLAN					
A	FOR DEVELOPMENT APPROVAL	24.11.2023	DM	Height Datum	AHD	Approved Signature			Project Number	Type	Discipline	Sub-Discipline	Drg No.	Rev
Rev	Description	Date	Drawn By						230790	Drg	CIV	0001	GN	E

File Name: P:\2023\230790_Lot-642-Googong\04_CAD\4_2_Drawings\CIV\230790-drg-civ-0101-a1.dwg

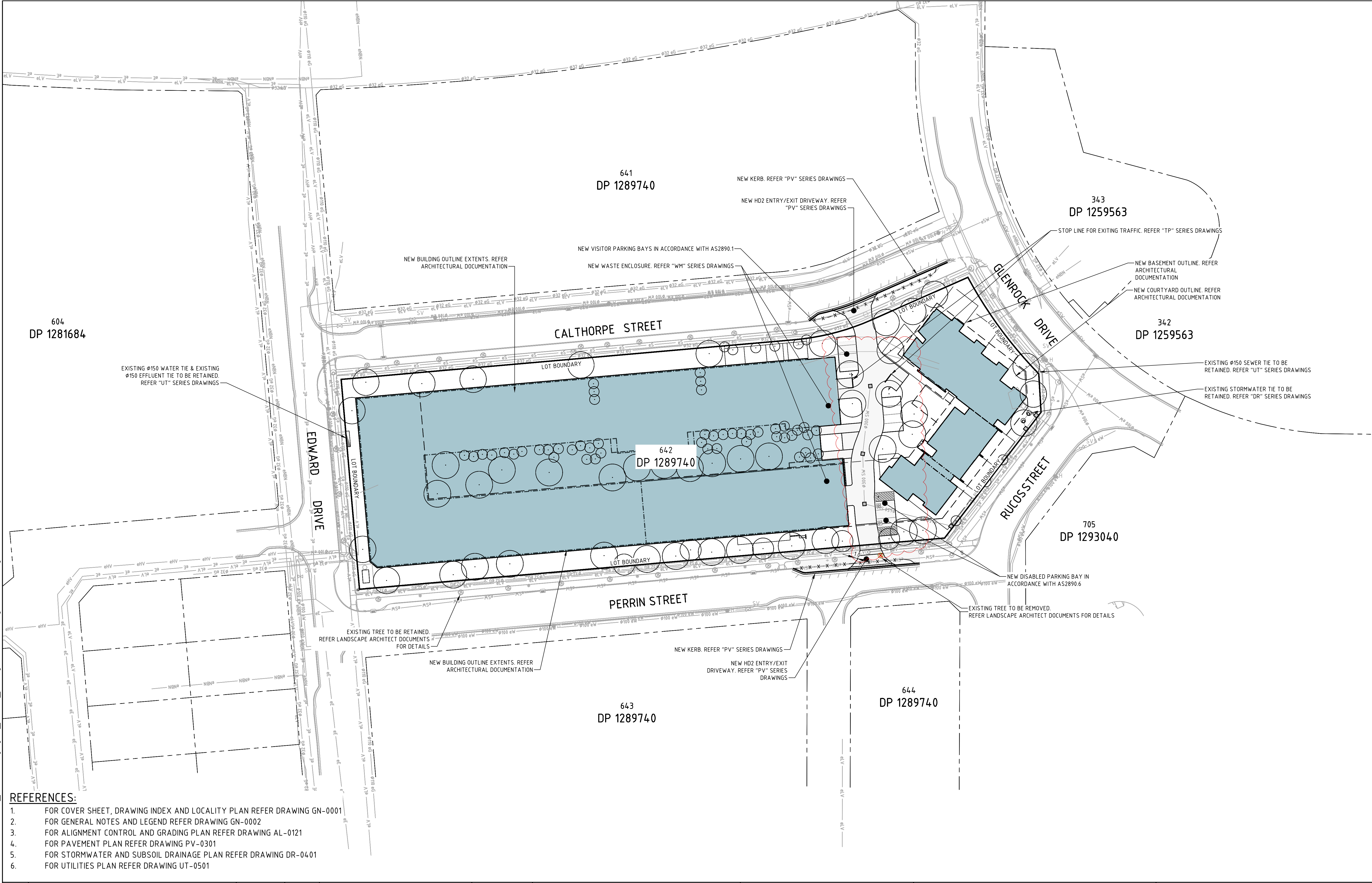

- REFERENCES:**
1. FOR COVER SHEET, DRAWING INDEX AND LOCALITY PLAN REFER DRAWING GN-0001
 2. FOR GENERAL NOTES AND LEGEND REFER DRAWING GN-0002
 3. FOR ALIGNMENT CONTROL AND GRADING PLAN REFER DRAWING AL-0121
 4. FOR PAVEMENT PLAN REFER DRAWING PV-0301
 5. FOR STORMWATER AND SUBSOIL DRAINAGE PLAN REFER DRAWING DR-0401
 6. FOR UTILITIES PLAN REFER DRAWING UT-0501

F	COUNCIL COMMENTS	26.07.2024	DM	<div>2025</div> <div>canberra sydney</div> <div>ABN 82 634 296 629</div>	<div>Client Logo</div> <div>BASE</div>	NOT FOR CONSTRUCTION			Project Name and Location					
E	FOR DEVELOPMENT APPROVAL	03.07.2024	DM			Original Size	A1	Drawn By	DM	Drafting Check	DA	MIXED USE DEVELOPMENT		
D	FOR DEVELOPMENT APPROVAL	01.07.2024	DM			Date Plotted	26-Jul-24	Designed By	LT	Design Check		GOOGONG		
C	FOR DEVELOPMENT APPROVAL	18.06.2024	DM			Coordinate System	STROMLO GRID	Approved	AM	Approved Date		GENERAL ARRANGEMENT		
B	FOR DEVELOPMENT APPROVAL	17.06.2024	DM			Height	AHD	Approved Signature				PLAN SHEET 1		
A	FOR DEVELOPMENT APPROVAL	24.11.2023	DM			Datum						Project Number	Type	
Rev	Description	Date	Drawn By	DO NOT SCALE OFF DRAWINGS. VERIFY ALL DIMENSIONS ON SITE PRIOR TO WORK. COPYRIGHT: The contents and information contained in this document are copyright of Sellick Consultants, Use or copy of this document in whole or part without written permission constitutes an infringement of copyright.					230790	DRG	CIV	Sub-Discipline	AL	
												Org No.	0101	
												Rev	F	

File Name: P:\2023\230790_Lot-642-Googong\04_CAD\4_2_Drawings\CIV\230790-drg-civ-0121-a1.dwg

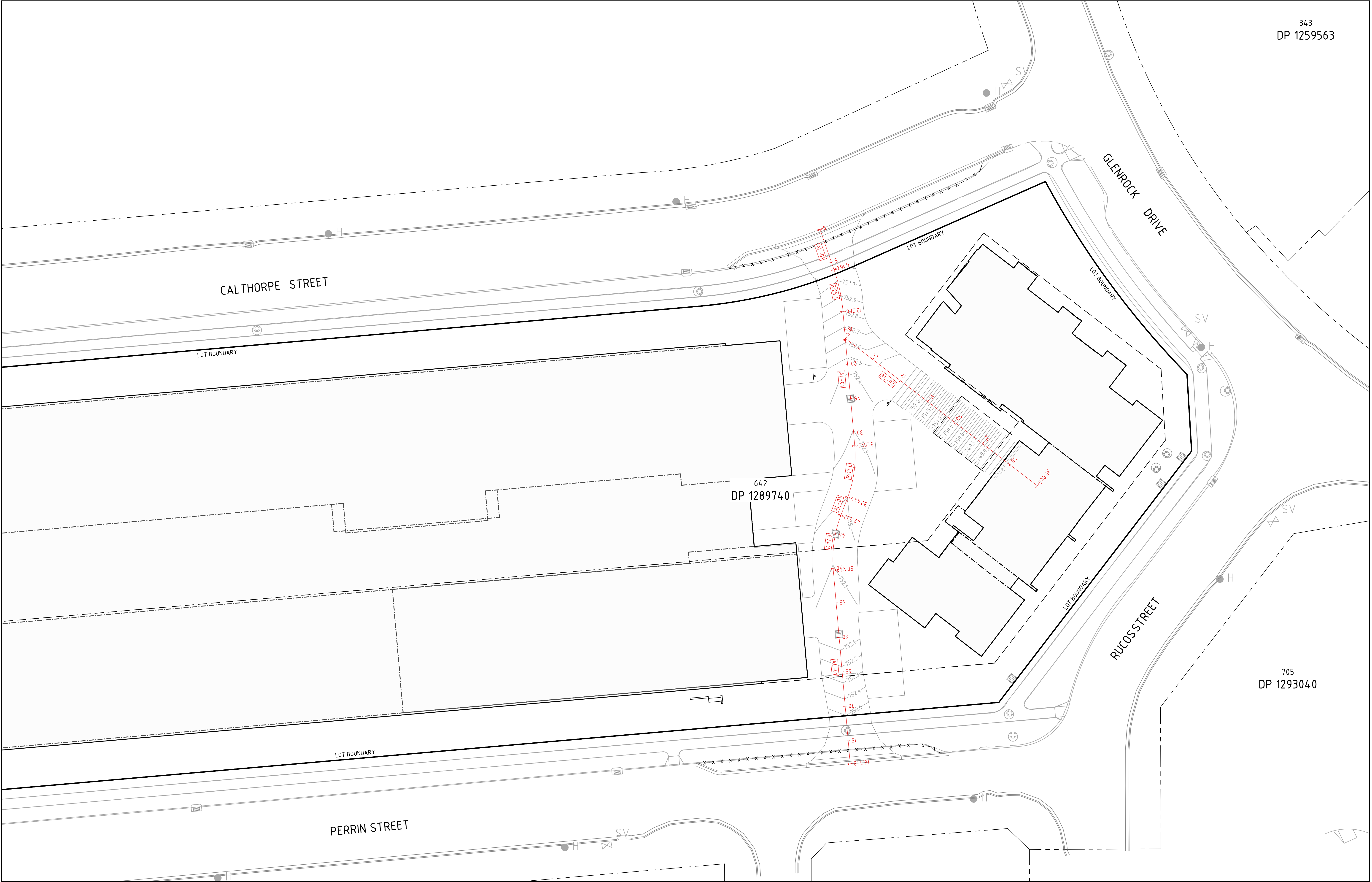

343
DP 1259563

642
DP 1289740

705
DP 1293040

				Scales		North		Client Logo				Status				Project Name and Location					
E	COUNCIL COMMENTS	26.07.2024	DM	 1:250 @ A1		 N		 canberra sydney ABN 82 634 296 629				NOT FOR CONSTRUCTION				MIXED USE DEVELOPMENT					
D	FOR DEVELOPMENT APPROVAL	03.07.2024	DM													GOOGONG					
C	FOR DEVELOPMENT APPROVAL	18.06.2024	DM	<div>DO NOT SCALE OFF DRAWINGS. VERIFY ALL DIMENSIONS ON SITE PRIOR TO WORK. COPYRIGHT: The contents and information contained in this document are copyright of Sellick Consultants, Use or copy of this document in whole or part without written permission constitutes an infringement of copyright.</div>								Drawing Title									
B	FOR DEVELOPMENT APPROVAL	17.06.2024	DM									ALIGNMENT									
A	FOR DEVELOPMENT APPROVAL	24.11.2023	DM									CONTROL AND GRADING PLAN									
Rev	Description	Date	Drawn By									Project Number				Type	Discipline	Sub-Discipline	Drq No.	Rev	
				230790				DRG	CIV	AL	0121	E									

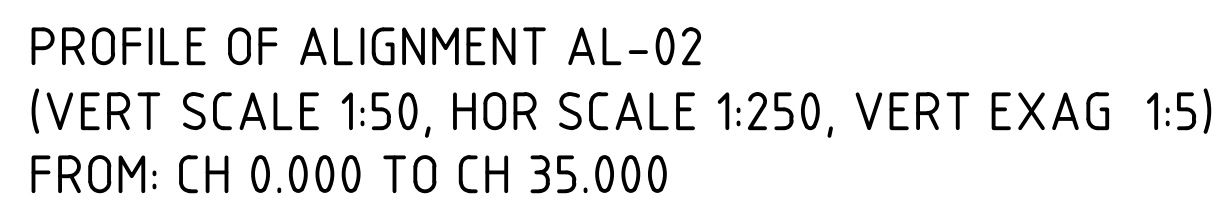
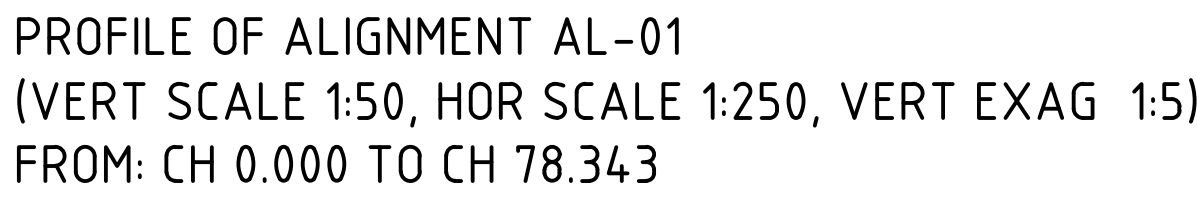

				Scales	North	 canberra sydney ABN 82 634 296 629	Client Logo 	Status NOT FOR CONSTRUCTION	Project Name and Location MIXED USE DEVELOPMENT GOOGONG								
E	COUNCIL COMMENTS	26.07.2024	DM						Original Size	A1	Drawn By	DM	Drafting Check	DA	Drawing Title ALIGNMENT ROAD LONGITUDINAL SECTIONS		
D	FOR DEVELOPMENT APPROVAL	03.07.2024	DM						Date Plotted	26-Jul-24	Designed By	LT	Design Check				
C	FOR DEVELOPMENT APPROVAL	18.06.2024	DM						Coordinate System	STROMLO GRID	Approved	AM	Approved Date				
B	FOR DEVELOPMENT APPROVAL	17.06.2024	DM						Height Datum	AHD	Approved Signature						
A	FOR DEVELOPMENT APPROVAL	24.11.2023	DM						DO NOT SCALE OFF DRAWINGS. VERIFY ALL DIMENSIONS ON SITE PRIOR TO WORK. COPYRIGHT: The contents and information contained in this document are copyright of Sellick Consultants, Use or copy of this document in whole or part without written permission constitutes an infringement of copyright.								
Rev	Description	Date	Drawn By	Project Number	Type	Discipline	Sub-Discipline	Drg No							Rev		
				230790	DRG	CIV	AL	0141	E								

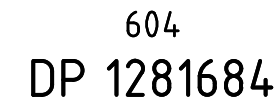

F	COUNCIL COMMENTS	26.07.2024	DM	<div>Scale</div> <div><div><div>010152025m</div><div>1:500 @ A1</div></div><div><div>North</div><div></div></div></div>	<div><div>canberra sydney</div><div>ABN 82 634 296 629</div></div>	<div>Client Logo</div> <div></div>	<div>Status</div> <div>NOT FOR CONSTRUCTION</div>				<div>Project Name and Location</div> <div>MIXED USE DEVELOPMENT</div>					
E	FOR DEVELOPMENT APPROVAL	03.07.2024	DM				<div>Original Size</div> <div>A1</div>	<div>Drawn By</div> <div>DM</div>	<div>Drafting Check</div> <div>DA</div>	<div>GOOGONG</div>						
D	FOR DEVELOPMENT APPROVAL	01.07.2024	DM				<div>Date Plotted</div> <div>26-Jul-24</div>	<div>Designed By</div> <div>LT</div>	<div>Design Check</div>	<div>Drawing Title</div> <div>PAVEMENT PLAN</div>						
C	FOR DEVELOPMENT APPROVAL	18.06.2024	DM				<div>Coordinate System</div> <div>STROMLO GRID</div>	<div>Approved</div> <div>AM</div>	<div>Approved Date</div>	<div>SHEET 1</div>						
B	FOR DEVELOPMENT APPROVAL	17.06.2024	DM				<div>Height Datum</div> <div>AHD</div>	<div>Approved Signature</div>		<div>Project Number</div> <div>230790</div>	<div>Type</div> <div>DRG</div>	<div>Discipline</div> <div>CIV</div>	<div>Sub-Discipline</div> <div>PV</div>	<div>Drp No</div> <div>0301</div>	<div>Rev</div> <div>F</div>	
A	FOR DEVELOPMENT APPROVAL	24.11.2023	DM	<div>DO NOT SCALE OFF DRAWINGS. VERIFY ALL DIMENSIONS ON SITE PRIOR TO WORK. COPYRIGHT: The contents and information contained in this document are copyright of Sellick Consultants. Use or copy of this document in whole or part without written permission constitutes an infringement of copyright.</div>												
Rev	Description	Date	Drawn By													

File Name: P:\2023\230790_Lot-642-Googong\04_CAD\4_2_Drawings\CV\230790-drg-civ-0910-ev.dwg

POLLUTION CONTROL NOTES

DEVELOPMENT CONTACT DETAILS

PROJECT MANAGER: **xTBC**

SITE MANAGER: **xTBC**

TOTAL SITE AREA: 11,99m²
AVERAGE EXISTING SITE SLOPE: 0.98%

SEDIMENT CONTROL NOTES

- SEDIMENT AND EROSION CONTROL DEVICES ARE TO BE INSTALLED IN ACCORDANCE WITH "ENVIRONMENT PROTECTION GUIDELINES FOR CONSTRUCTION AND DEVELOPMENT IN THE ACT 2022" AND FULLY OPERATIONAL PRIOR TO STRIPPING OF SITE TOP SOIL.
- STOCK PILE/S TO BE LOCATED AWAY FROM DRAINAGE LINES AND SURFACE FLOW PATHS. CONTOURED STRIATIONS OR FURROWS TO BE PROVIDED TO STOCK PILES TO MINIMISE EROSION.
- STABILISED CONSTRUCTION ENTRANCE TO BE CONSTRUCTED PRIOR TO ACCESS TO SITE BY CONSTRUCTION VEHICLES. AGGREGATE TO BE TURNED WHEN SEDIMENT BUILDS UP AND RENEWED WHEN REQUIRED.
- WHERE UNDERGROUND STORMWATER DRAINAGE IS INSTALLED TO INTERNAL ROADWORKS, PROVIDE INLET FILTER.
- ENVIRONMENT PROTECTION AGREEMENT TO BE TAKEN OUT BY CONTRACTOR WITH ENVIRONMENT PROTECTION AUTHORITY. (TELEPHONE 132 281)
- ALL NEW CONSTRUCTION WORK MUST BE CONTAINED WITHIN THE SITE EXCEPT FOR APPROVED SERVICE CONNECTIONS AND ROADWORKS.
- LIMIT ACCESS TO SITE DURING AND IMMEDIATELY AFTER WET WEATHER.
- REGULARLY REMOVE ANY SOIL FROM ROADS ADJACENT TO THE SITE.
- NO STORAGE OF CONSTRUCTION MATERIALS, PARKING OF VEHICLES NOR EQUIPMENT PERMITTED OUTSIDE OF BLOCK WITHOUT TCCS APPROVAL.
- NO SITE SHEDS, STORAGE SHEDS OR SITE AMENITIES TO BE ERECTED OUTSIDE OF BLOCK WITHOUT TCCS APPROVAL.
- PROVIDE KERBSIDE FILTER ROLL TO EXISTING SUMPS WHERE INDICATED.
- KERBSIDE FILTER ROLLS TO BE REMOVED, CLEANED AND REINSTATED ON A WEEKLY BASIS AT A MINIMUM. TRAPPED SEDIMENT ABOUT SUMPS ALSO TO BE REMOVED. CLEANING IS ALSO TO TAKE PLACE IMMEDIATELY AFTER PERIODS OF RAINFALL DURING CONSTRUCTION.
- ALL SERVICE TRENCHES TO BE BACK FILLED WITHIN 24 HOURS OF INSPECTION.
- EXCESS SOIL IS TO BE DISPOSED AT AN ENVIRONMENT PROTECTION AUTHORITY APPROVED LOCATION.
- THE SITE FOREMAN IS TO CONTACT THE ENVIRONMENT PROTECTION AUTHORITY (132281) TO ARRANGE A SITE INSPECTION AND ENDORSEMENT OF SEDIMENT AND EROSION CONTROL MEASURES PRIOR TO WORKS COMMENCING.
- THE SITE FOREMAN IS TO CONTACT THE ENVIRONMENT PROTECTION AUTHORITY (132281) TO DISCUSS ANY PROPOSED MAJOR CHANGES TO SEDIMENT AND EROSION CONTROLS ON SITE PRIOR TO IMPLEMENTING THE CHANGES.
- THE SITE FOREMAN IS TO ENSURE CONTRACTOR'S ACCESS AND EXIT THE SITE USING ONLY ENVIRONMENT PROTECTION AUTHORITY APPROVED STABILISED ACCESS/EXIT POINTS AS DETAILED ON ENDORSED SEDIMENT AND EROSION CONTROL PLANS.
- FOR SITES 1 HECTARE OR GREATER, A TEMPORARY SEDIMENT POND SHALL BE CONSTRUCTED. THE SEDIMENT POND SHALL BE SIZED IN ACCORDANCE WITH ENVIRONMENTAL PROTECTION GUIDELINES FOR CONSTRUCTION AND DEVELOPMENT IN THE ACT 2022. DISCHARGE FROM THE POND IS PERMISSIBLE WHEN THE WATER pH IS 6.5-8.5 AND IS CLARIFIED TO OR AT BELOW 60mg/L (50NTU). IF SEDIMENT LEVEL IS GREATER, THEN PRIOR TO DISCHARGE, THE DAM MUST BE DOSED WITH EITHER ALUM OR GYPSUM AND ALLOWED TO SETTLE UNTIL THE SEDIMENT IS LESS THAN 60mg/L (50NTU).
- INSTALL A WATER LEVEL INDICATOR IDENTIFYING 'SEDIMENT AT 10% CAPACITY' AND 'WATER AT 20% CAPACITY'. THE LENGTH TO WIDTH RATIO IS A MINIMUM OF 3:1
- CLEAN OUT SEDIMENT BUILD-UP WHEN IT IS ABOVE THE 10% WATER LEVEL INICATOR. WATER SHOULD BE MAINTAINED AT 20% CAPACITY
- THE TOTAL CATCHMENT AREA (INCLUDING DISTURBED AND UNDISTURBED) SHOULD NOT EXCEED 40 HECTARES
- WATER LEVEL TO BE MAINTAINED AT LESS THAN 20% OF CAPACITY TO ALLOW RUNOFF STORAGE DURING A RAIN EVENT.
- REGULAR DREDGING OF THE DAM MUST BE CARRIED OUT TO REMOVE SILT.
- SITE DRAWING AND DETAILS MUST BE PROVIDED TO ENVIRONMENT PROTECTION AUTHORITY, FOR APPROVAL PRIOR TO WORKS COMMENCING.

WASTE NOTES

- WASTE ENCLOSURE(S) ARE TO BE USED FOR ALL RUBBISH ON SITE AND RUBBISH REMOVED FROM ENCLOSURE(S) WHEN REQUIRED OR FULL.

DISPOSAL OF SPOIL

PRIOR TO ANY WORKS COMMENCING INVOLVING EXPORT OF SPOIL GREATER THAN 100m³, THE FOLLOWING INFORMATION MUST BE PROVIDED TO THE ENVIRONMENT PROTECTION AUTHORITY VIA EMAIL (environment.protection@act.gov.au):

- WHERE THE SPOIL WILL ORIGINATE FROM: WHO IS DISPOSING OF THE SPOIL: WHERE THE SPOIL WILL BE TAKEN: THE AMOUNT OF SPOIL TO BE TAKEN AWAY;
- MOVEMENT DATES AND CONTACT DETAILS: DESCRIPTION OF THE TYPE OF SPOIL TAKEN AWAY:DETAILS OF HOW RECORDS WILL BE KEPT; AND

- TIME FRAME TO COMPLETE THE WORKS TO THE SATISFACTION OF THE ENVIRONMENT PROTECTION AUTHORITY.
- SPOIL MAY BE TAKEN TO AN APPROVED LANDFILL SITE WITHOUT APPROVAL. IF THE SPOIL IS TO BE TAKEN TO AN AREA OTHER THAN AN APPROVED LANDFILL SITE, ENSURE THE ACCEPTOR OF THE SPOIL IS AWARE OF THE REQUIREMENTS SETOUT IN SECTION 8.2 OF THE ENVIRONMENT PROTECTION GUIDELINES FOR CONSTRUCTION AND LAND DEVELOPMENT IN THE ACT.

NOISE

ENSURE ALL BUILDING WORK THAT GENERATES NOISE IS CONDUCTED WITHIN THE TIME PERIODS DETAILED IN SCHEDULE 2 OF THE ENVIRONMENT PROTECTION REGULATIONS 2005.

BUILDING WORK DETAILS	MONDAY TO SATURDAY	SUNDAY AND PUBLIC HOLIDAYS
INDUSTRIAL, CITY AND TOWN CENTRE AREAS	6AM TO 8PM	6AM TO 8PM
ANY OTHER AREA WHEN WORK COMPLETED WITHIN 2 WEEKS	7AM TO 6PM	8AM TO 8PM
ANY OTHER AREA WHEN WORK NOT COMPLETED WITHIN 2 WEEKS	7AM TO 6PM	CONSTRUCTION WORK MUST NOT EXCEED NOISE STANDARD

IN ADDITION:

- SCHEDULE NOISY ACTIVITIES FOR THE LEAST SENSITIVE TIMES OF THE DAY SUCH AS MID-MORNING AND MID-AFTERNOON.
- SELECT MACHINERY THAT PRODUCE LESS NOISE; AND
- ENSURE MACHINERY IS WELL MAINTAINED.

DUST MANAGEMENT

WHERE BUILDING WORK GENERATES DUST, ALL REASONABLE AND PRACTICABLE MEASURES SHOULD BE TAKEN TO MINIMISE THAT DUST. THIS CAN OFTEN BE ACHIEVED BY:

- RETAINING EXISTING VEGETATION WHERE POSSIBLE.
- STRIPPING AREAS PROGRESSIVELY AND ONLY WHERE IT IS NECESSARY FOR WORKS TO OCCUR.
- EMPLOYING STABILISING METHODS SUCH AS MATTING, GRASSING OR MULCH.
- DAMPENING THE GROUND WITH A LIGHT WATER SPRAY (CONTACT THE ENVIRONMENT PROTECTION AUTHORITY FOR REQUIREMENTS DURING EXTREME DROUGHT CONDITIONS).
- ROUGHENING SURFACE OF EXPOSED SOIL.
- COVERING STOCKPILES AND LOCATING THEM WHERE THEY ARE PROTECTED FROM THE WIND.
- RESTRICTING VEHICLE MOVEMENTS.
- COVERING THE LOAD WHEN TRANSPORTING MATERIAL.
- CONSTRUCTING WIND BREAKS SUCH AS WIND FENCES IN ACCORDANCE WITH THE BLUE BOOK.
- A WATER CART OR SUFFICIENT WATER SPRAYS SHALL BE MADE AVAILABLE AT ALL TIMES. IN ADVERSE CONDITIONS WHEN DUST CANNOT BE ADEQUATELY CONTROLLED WHEN WORKS ARE BEING UNDERTAKEN, WORKS WILL CEASE IN THESE AREAS UNTIL CONDITIONS IMPROVE.
- WATER SHALL BE APPLIED TO SUPPRESS DUST FROM OPEN EARTHWORKS AS WELL AS UNPROTECTED STOCKPILES.
- AREAS OF COMPLETED EARTHWORKS SHALL BE PROGRESSIVELY REHABILITATED WITH DRYLAND GRASS AND FENCED OFF AS SOON AS PRACTICABLE TO PREVENT FURTHER EROSION.
- THE CONTRACTOR SHALL CONTACT ICON WATER TO OBTAIN RECYCLED WATER FROM THE LOWER MOLONGLO.
- THE CONTRACTOR IS TO CONTACT THE WATER RESOURCES UNIT TO OBTAIN AN EXEMPTION TO USE NON-POTABLE WATER FROM ON OR OFF THE SITE IF REQUIRED.
- DURING WINDY CONDITIONS, THE CONTRACTOR IS TO MINIMISE DUST GENERATING ACTIVITIES AND REGULARLY APPLY DUST SUPPRESSING MEASURES. IF DUST SUPPRESSION MEASURES FAIL THE CONTRACTOR IS TO CEASE DUST GENERATING ACTIVITIES.

FIRE

- BURNING OF WASTE MATERIALS ON THE SITE, SUCH AS PLASTICS, CHEMICALS OR WOOD THAT MAY BE PAINTED, CHEMICALLY TREATED OR CONTAMINATED WITH CHEMICALS IS ILLEGAL.
- A FIRE MAY BE PERMITTED FOR HEATING PURPOSES PROVIDED IT IS IN A BRAZIER OR CONSTRUCTED FIREPLACE. ONLY SEASONED, UNTREATED TIMBER CAN BE BURNED FOR HEATING PURPOSES.

MAINTENANCE SCHEDULE

DAILY:

- CHECK AND REINSTATE SILT CONTROL FENCES.
- SWEEP AND REMOVE DIRT AND ANY OTHER BUILDING MATERIAL FROM GUTTERS, FOOTPATHS AND ROADWAYS ADJACENT TO THE SITE BY CLOSE OF BUSINESS AND PRIOR TO RAIN AND AS REQUIRED. ALL NECESSARY STEPS SHOULD BE TAKEN THAT ARE PRACTICAL AND REASONABLE TO MINIMISE DUST POLLUTION.

MONTHLY:

- STABILISED CONSTRUCTION ENTRANCE AGGREGATE TO BE TURNED AND RENEWED.

DURING/AFTER WET WEATHER:

- LIMIT CONSTRUCTION VEHICLE ACCESS TO SITE DURING AND IMMEDIATELY FOLLOWING WET WEATHER. CHECK AND REINSTATE SEDIMENT EROSION CONTROL MEASURES AND CHECK ROAD.

LEGEND

SITE BOUNDARY

SITE / SECURITY FENCE

VERGE FENCE

SITE GATES (INDICATIVE)
-GATES TO OPEN INTO SITE

STABILISED CONSTRUCTION
ENTRANCE LOCATION

SITE SHEDS (INDICATIVE)

EXISTING CONTOUR

EXISTING TREE TO BE RETAINED
>(INDICATIVE SYMBOL SHOWN)

EXISTING TREE TO BE REMOVED

SILT FENCE (PRIOR TO ANY EXCAVATION)

KERB INLET FILTER

SEDIMENT & EROSION CONTROL POND

HAY BALES

canberra | sydney

ABN 82 634 296 629



NOT FOR CONSTRUCTION				Project Name and Location					
				MIXED USE DEVELOPMENT					
Original Size	A1	Drawn By	DM	Drafting Check	GOOGONG				
Date Plotted	26-Jul-24	Designed By	LT	Design Check	Drawing Title				
Coordinate System	STROMLO GRID	Approved	AM	Approved Date	SEDIMENT EROSION CONTROL NOTES AND LEGEND				
Height Datum	AHD	Approved Signature			Project Number	Type	Discipline	Sub-Discipline	Drg No. Rev
					230790	DRG	CIV	EV	0910 E

File Name: P:\2023\230790_Lot-642-Googong\04_CAD\4_2_Drawings\CIV\230790-drg-civ-0911-ev.dwg

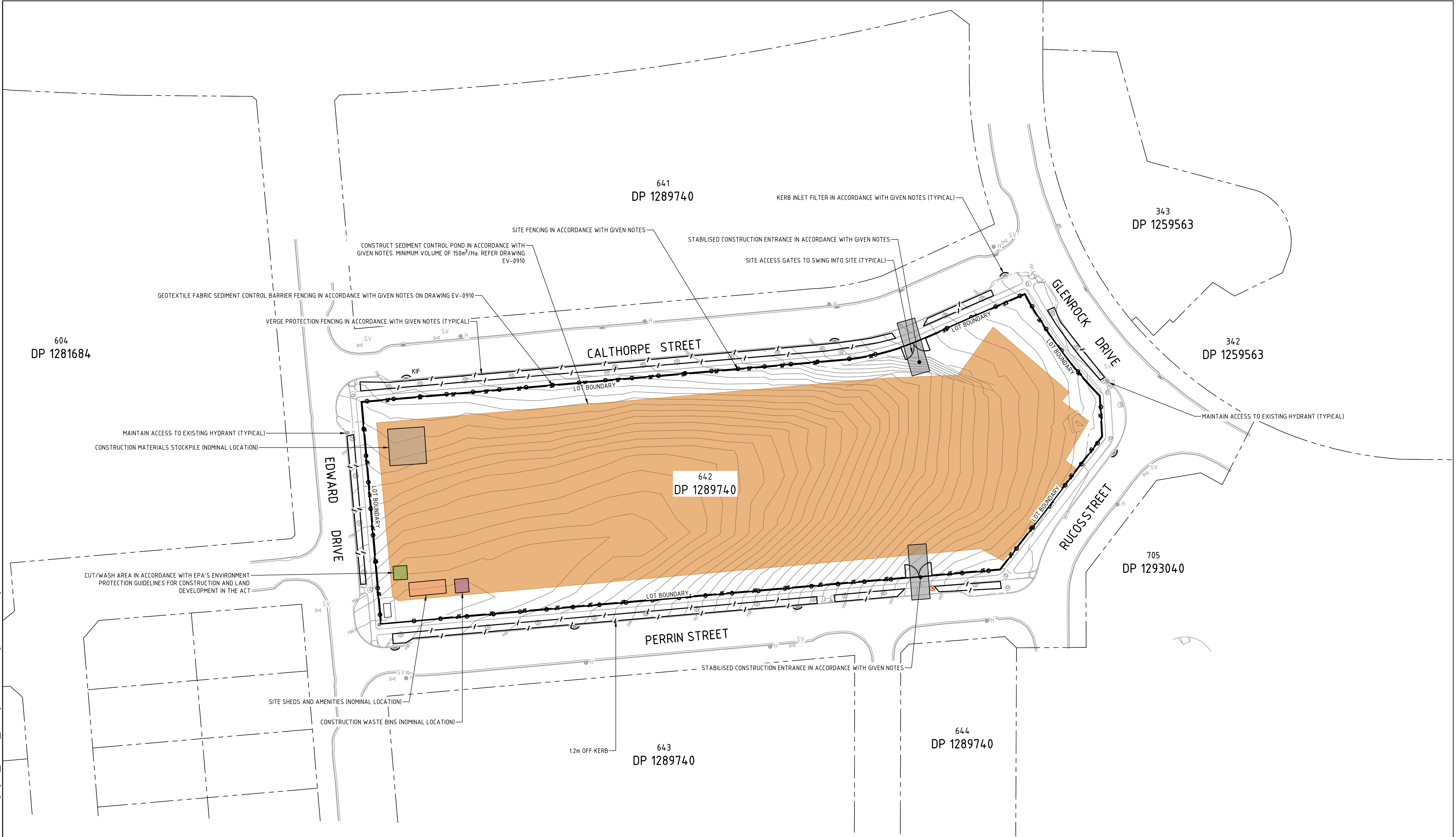

- REFERENCES:
- 1. FOR COVER SHEET, DRAWING INDEX AND LOCALITY PLAN REFER DRAWING GN-0001
 - 2. FOR GENERAL NOTES AND LEGEND REFER DRAWING GN-0002
 - 3. FOR UTILITIES DETAILS REFER DRAWING UT-0511

																																																																																																																																																																																																																																																																																																																																																																																																																																																																																																																																																																																																																																																																																																																																																																																																																																																																																																																																																																																																																																																																																																																																																																																																																																																																																																																																																																																																																					</
--	--	--	--	--	--	--	--	--	--	--	--	--	--	--	--	--	--	--	--	--	--	--	--	--	--	--	--	--	--	--	--	--	--	--	--	--	--	--	--	--	--	--	--	--	--	--	--	--	--	--	--	--	--	--	--	--	--	--	--	--	--	--	--	--	--	--	--	--	--	--	--	--	--	--	--	--	--	--	--	--	--	--	--	--	--	--	--	--	--	--	--	--	--	--	--	--	--	--	--	--	--	--	--	--	--	--	--	--	--	--	--	--	--	--	--	--	--	--	--	--	--	--	--	--	--	--	--	--	--	--	--	--	--	--	--	--	--	--	--	--	--	--	--	--	--	--	--	--	--	--	--	--	--	--	--	--	--	--	--	--	--	--	--	--	--	--	--	--	--	--	--	--	--	--	--	--	--	--	--	--	--	--	--	--	--	--	--	--	--	--	--	--	--	--	--	--	--	--	--	--	--	--	--	--	--	--	--	--	--	--	--	--	--	--	--	--	--	--	--	--	--	--	--	--	--	--	--	--	--	--	--	--	--	--	--	--	--	--	--	--	--	--	--	--	--	--	--	--	--	--	--	--	--	--	--	--	--	--	--	--	--	--	--	--	--	--	--	--	--	--	--	--	--	--	--	--	--	--	--	--	--	--	--	--	--	--	--	--	--	--	--	--	--	--	--	--	--	--	--	--	--	--	--	--	--	--	--	--	--	--	--	--	--	--	--	--	--	--	--	--	--	--	--	--	--	--	--	--	--	--	--	--	--	--	--	--	--	--	--	--	--	--	--	--	--	--	--	--	--	--	--	--	--	--	--	--	--	--	--	--	--	--	--	--	--	--	--	--	--	--	--	--	--	--	--	--	--	--	--	--	--	--	--	--	--	--	--	--	--	--	--	--	--	--	--	--	--	--	--	--	--	--	--	--	--	--	--	--	--	--	--	--	--	--	--	--	--	--	--	--	--	--	--	--	--	--	--	--	--	--	--	--	--	--	--	--	--	--	--	--	--	--	--	--	--	--	--	--	--	--	--	--	--	--	--	--	--	--	--	--	--	--	--	--	--	--	--	--	--	--	--	--	--	--	--	--	--	--	--	--	--	--	--	--	--	--	--	--	--	--	--	--	--	--	--	--	--	--	--	--	--	--	--	--	--	--	--	--	--	--	--	--	--	--	--	--	--	--	--	--	--	--	--	--	--	--	--	--	--	--	--	--	--	--	--	--	--	--	--	--	--	--	--	--	--	--	--	--	--	--	--	--	--	--	--	--	--	--	--	--	--	--	--	--	--	--	--	--	--	--	--	--	--	--	--	--	--	--	--	--	--	--	--	--	--	--	--	--	--	--	--	--	--	--	--	--	--	--	--	--	--	--	--	--	--	--	--	--	--	--	--	--	--	--	--	--	--	--	--	--	--	--	--	--	--	--	--	--	--	--	--	--	--	--	--	--	--	--	--	--	--	--	--	--	--	--	--	--	--	--	--	--	--	--	--	--	--	--	--	--	--	--	--	--	--	--	--	--	--	--	--	--	--	--	--	--	--	--	--	--	--	--	--	--	--	--	--	--	--	--	--	--	--	--	--	--	--	--	--	--	--	--	--	--	--	--	--	--	--	--	--	--	--	--	--	--	--	--	--	--	--	--	--	--	--	--	--	--	--	--	--	--	--	--	--	--	--	--	--	--	--	--	--	--	--	--	--	--	--	--	--	--	--	--	--	--	--	--	--	--	--	--	--	--	--	--	--	--	--	--	--	--	--	--	--	--	--	--	--	--	--	--	--	--	--	--	--	--	--	--	--	--	--	--	--	--	--	--	--	--	--	--	--	--	--	--	--	--	--	--	--	--	--	--	--	--	--	--	--	--	--	--	--	--	--	--	--	--	--	--	--	--	--	--	--	--	--	--	--	--	--	--	--	--	--	--	--	--	--	--	--	--	--	--	--	--	--	--	--	--	--	--	--	--	--	--	--	--	--	--	--	--	--	--	--	--	--	--	--	--	--	--	--	--	--	--	--	--	--	--	--	--	--	--	--	--	--	--	--	--	--	--	--	--	--	--	--	--	--	--	--	--	--	--	--	--	--	--	--	--	--	--	--	--	--	--	--	--	--	--	--	--	--	--	--	--	--	--	--	--	--	--	--	--	--	--	--	--	--	--	--	--	--	--	--	--	--	--	--	--	--	--	--	--	--	--	--	--	--	--	--	--	--	--	--	--	--	--	--	--	--	--	--	--	--	--	--	--	--	--	--	--	--	--	--	--	--	--	--	--	--	--	--	--	--	--	--	--	--	--	--	--	--	--	--	--	--	--	--	--	--	--	--	--	--	--	--	--	--	--	--	--	--	--	--	--	--	--	--	--	--	--	--	--	--	--	--	--	--	--	--	--	--	--	--	--	--	--	--	--	--	--	--	--	--	--	--	--	--	--	--	--	--	--	--	--	--	--	--	--	--	--	--	--	--	--	--	--	--	--	--	--	--	--	--	--	--	--	--	--	--	--	--	--	--	--	--	--	--	--	--	--	--	--	--	--	--	--	--	--	--	--	--	--	--	--	--	--	--	--	--	--	--	--	--	--	--	--	--	--	--	--	--	--	--	--	--	--	--	--	--	--	--	--	--	--	--	--	--	--	--	--	--	--	--	--	--	--	--	--	--	--	--	--	--	--	--	--	--	--	--	--	--	--	--	--	--	--	--	--	--	--	--	--	--	--	--	--	--	--	--	--	--	--	--	--	--	--	--	--	--	--	--	--	--	--	--	--	--	--	--	--	--	--	--	--	--	--	--	--	--	--	--	--	--	--	--	--	--	--	--	--	--	--	--	--	--	--	--	--	--	--	--	--	--	--	--	--	--	--	--	--	--	--	--	--	--	--	--	--	--	--	--	--	--	--	--	--	--	--	--	--	--	--	--	--	--	--	--	--	--	--	--	--	--	--	--	--	--	--	--	--	--	--	--	--	--	--	--	--	--	--	--	--	--	--	--	--	--	--	--	--	--	--	--	--	--	--	--	--	--	--	--	--	--	--	--	--	--	--	--	--	--	--	--	--	--	--	--	--	--	--	--	--	--	--	--	--	--	--	--	--	--	--	----

File Name: P:\2023\230790_Lot-642-Googong\04_CAD\4.2_Drawings\CIV\230790-drg-civ-2201-1p.dwg



<table><tr><td>F</td><td>COUNCIL COMMENTS</td><td>26.07.2024</td><td>DM</td></tr><tr><td>E</td><td>FOR DEVELOPMENT APPROVAL</td><td>03.07.2024</td><td>DM</td></tr><tr><td>D</td><td>FOR DEVELOPMENT APPROVAL</td><td>01.07.2024</td><td>DM</td></tr><tr><td>C</td><td>FOR DEVELOPMENT APPROVAL</td><td>18.06.2024</td><td>DM</td></tr><tr><td>B</td><td>FOR DEVELOPMENT APPROVAL</td><td>17.06.2024</td><td>DM</td></tr><tr><td>A</td><td>FOR DEVELOPMENT APPROVAL</td><td>24.11.2023</td><td>DM</td></tr><tr><td>Rev</td><td>Description</td><td>Date</td><td>Drawn By</td></tr></table>				F	COUNCIL COMMENTS	26.07.2024	DM	E	FOR DEVELOPMENT APPROVAL	03.07.2024	DM	D	FOR DEVELOPMENT APPROVAL	01.07.2024	DM	C	FOR DEVELOPMENT APPROVAL	18.06.2024	DM	B	FOR DEVELOPMENT APPROVAL	17.06.2024	DM	A	FOR DEVELOPMENT APPROVAL	24.11.2023	DM	Rev	Description	Date	Drawn By	<p>Scales</p> <p>0 5 7.5 10 12.5m</p> <p>1:250 @ A1</p> <p>North</p> <p>DO NOT SCALE OFF DRAWINGS. VERIFY ALL DIMENSIONS ON SITE PRIOR TO WORK. COPYRIGHT: The contents and information contained in this document are copyright of Sellick Consultants, Use or copy of this document in whole or part without written permission constitutes an infringement of copyright.</p>		<p>Client Logo</p> <p> canberra sydney ABN 82 634 296 629</p>		<table><tr><td colspan="6">Status</td></tr><tr><td colspan="6">NOT FOR CONSTRUCTION</td></tr><tr><td>Original Size</td><td>A1</td><td>Drawn By</td><td>DM</td><td>Drafting Check</td><td>DA</td></tr><tr><td>Date Plotted</td><td>26-Jul-24</td><td>Designed By</td><td>LT</td><td>Design Check</td><td></td></tr><tr><td>Coordinate System</td><td>STROMLO GRID</td><td>Approved</td><td>AM</td><td>Approved Date</td><td></td></tr><tr><td>Height Datum</td><td>AHD</td><td colspan="4">Approved Signature</td></tr></table>				Status						NOT FOR CONSTRUCTION						Original Size	A1	Drawn By	DM	Drafting Check	DA	Date Plotted	26-Jul-24	Designed By	LT	Design Check		Coordinate System	STROMLO GRID	Approved	AM	Approved Date		Height Datum	AHD	Approved Signature				<table><tr><td colspan="6">Project Name and Location</td></tr><tr><td colspan="6">MIXED USE DEVELOPMENT</td></tr><tr><td colspan="6">GOOGONG</td></tr><tr><td colspan="6">Drawing Title</td></tr><tr><td colspan="6">VEHICLE TURNING PATHS PLAN</td></tr><tr><td colspan="6">SHEET 1</td></tr><tr><td>Project Number</td><td>Type</td><td>Discipline</td><td>Sub-Discipline</td><td>Drg No.</td><td>Rev</td></tr><tr><td>230790</td><td>DRG</td><td>CIV</td><td>TP</td><td>2201</td><td>F</td></tr></table>						Project Name and Location						MIXED USE DEVELOPMENT						GOOGONG						Drawing Title						VEHICLE TURNING PATHS PLAN						SHEET 1						Project Number	Type	Discipline	Sub-Discipline	Drg No.	Rev	230790	DRG	CIV	TP	2201	F
F	COUNCIL COMMENTS	26.07.2024	DM																																																																																																																														
E	FOR DEVELOPMENT APPROVAL	03.07.2024	DM																																																																																																																														
D	FOR DEVELOPMENT APPROVAL	01.07.2024	DM																																																																																																																														
C	FOR DEVELOPMENT APPROVAL	18.06.2024	DM																																																																																																																														
B	FOR DEVELOPMENT APPROVAL	17.06.2024	DM																																																																																																																														
A	FOR DEVELOPMENT APPROVAL	24.11.2023	DM																																																																																																																														
Rev	Description	Date	Drawn By																																																																																																																														
Status																																																																																																																																	
NOT FOR CONSTRUCTION																																																																																																																																	
Original Size	A1	Drawn By	DM	Drafting Check	DA																																																																																																																												
Date Plotted	26-Jul-24	Designed By	LT	Design Check																																																																																																																													
Coordinate System	STROMLO GRID	Approved	AM	Approved Date																																																																																																																													
Height Datum	AHD	Approved Signature																																																																																																																															
Project Name and Location																																																																																																																																	
MIXED USE DEVELOPMENT																																																																																																																																	
GOOGONG																																																																																																																																	
Drawing Title																																																																																																																																	
VEHICLE TURNING PATHS PLAN																																																																																																																																	
SHEET 1																																																																																																																																	
Project Number	Type	Discipline	Sub-Discipline	Drg No.	Rev																																																																																																																												
230790	DRG	CIV	TP	2201	F																																																																																																																												

File Name: P:\2023\230790_Lot-642-Googong\04_CAD\4.2_Drawings\CIV\230790-drg-civ-2203-tp.dwg

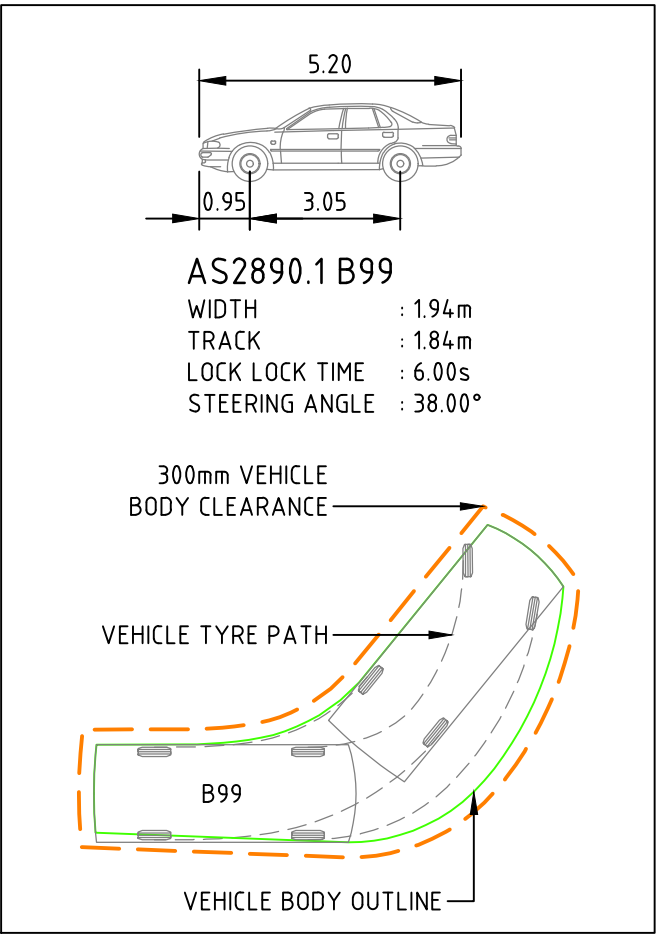
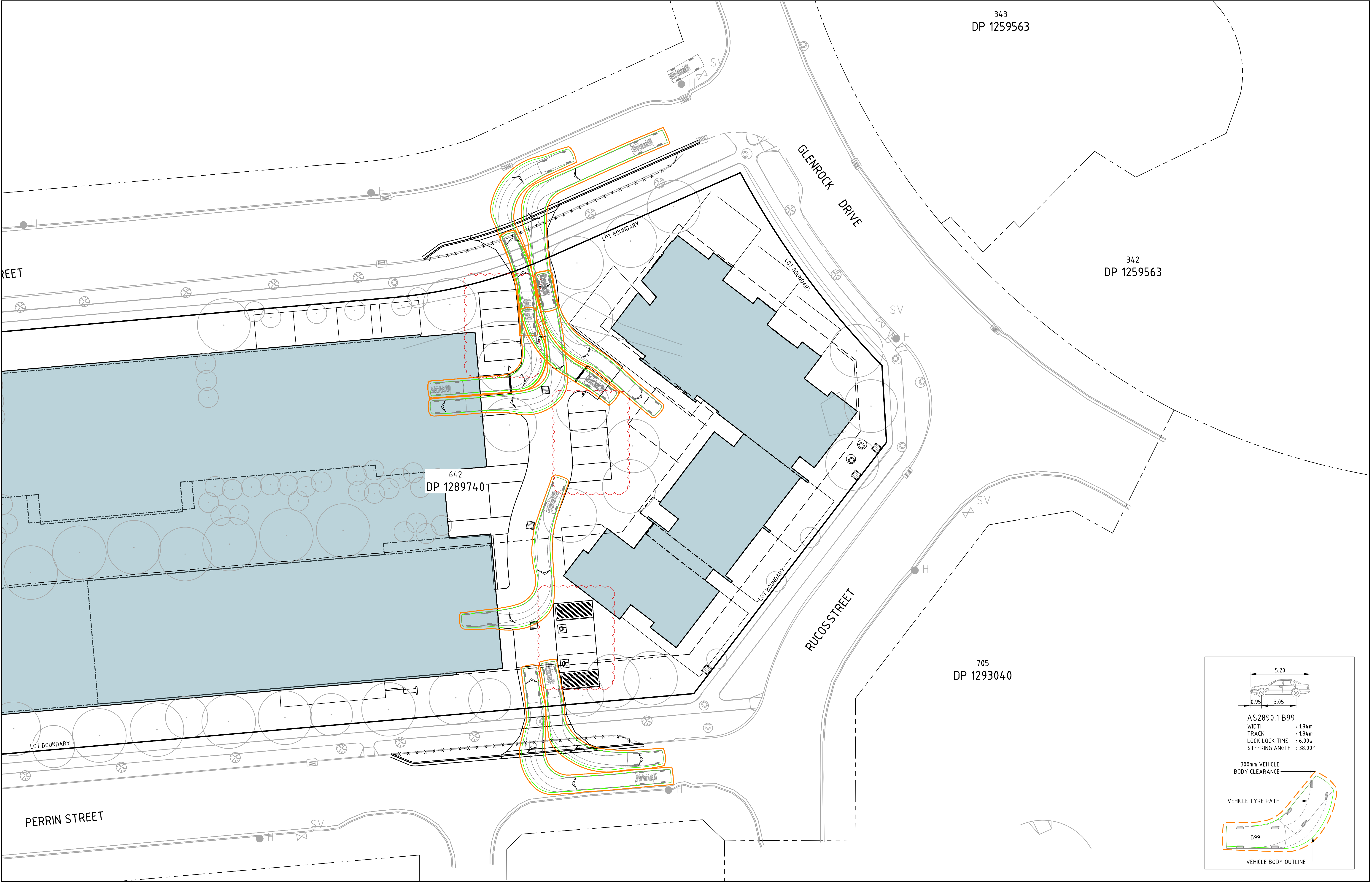

Rev	Description	Date	Drawn By
D	COUNCIL COMMENTS	26.07.2024	DM
C	FOR DEVELOPMENT APPROVAL	03.07.2024	DM
B	FOR DEVELOPMENT APPROVAL	01.07.2024	DM
A	FOR DEVELOPMENT APPROVAL	16.06.2024	DM

Scales

057.51012.5m

1:250 @ A1

North

DO NOT SCALE OFF DRAWINGS. VERIFY ALL DIMENSIONS ON SITE PRIOR TO WORK.

COPYRIGHT: The contents and information contained in this document are copyright of Sellick Consultants, Use or copy of this document in whole or part without written permission constitutes an infringement of copyright.



NOT FOR CONSTRUCTION			
Original Size	A1	Drawn By	DM
Date Plotted	26-Jul-24	Designed By	LT
Coordinate System	STROMLO GRID	Approved	AM
Height Datum	AHD	Approved Signature	

Project Name and Location					
GOOGONG					
Drawing Title					
VEHICLE TURNING PATHS PLAN					
SHEET 3					
Project Number	Type	Discipline	Sub-Discipline	Drg No.	Rev
230790	DRG	CIV	TP	2203	D

File Name: P:\2023\230790_Lot-642-Googong\04_CAD\4.2_Drawings\CIV\230790-drg-civ-2204-tp.dwg

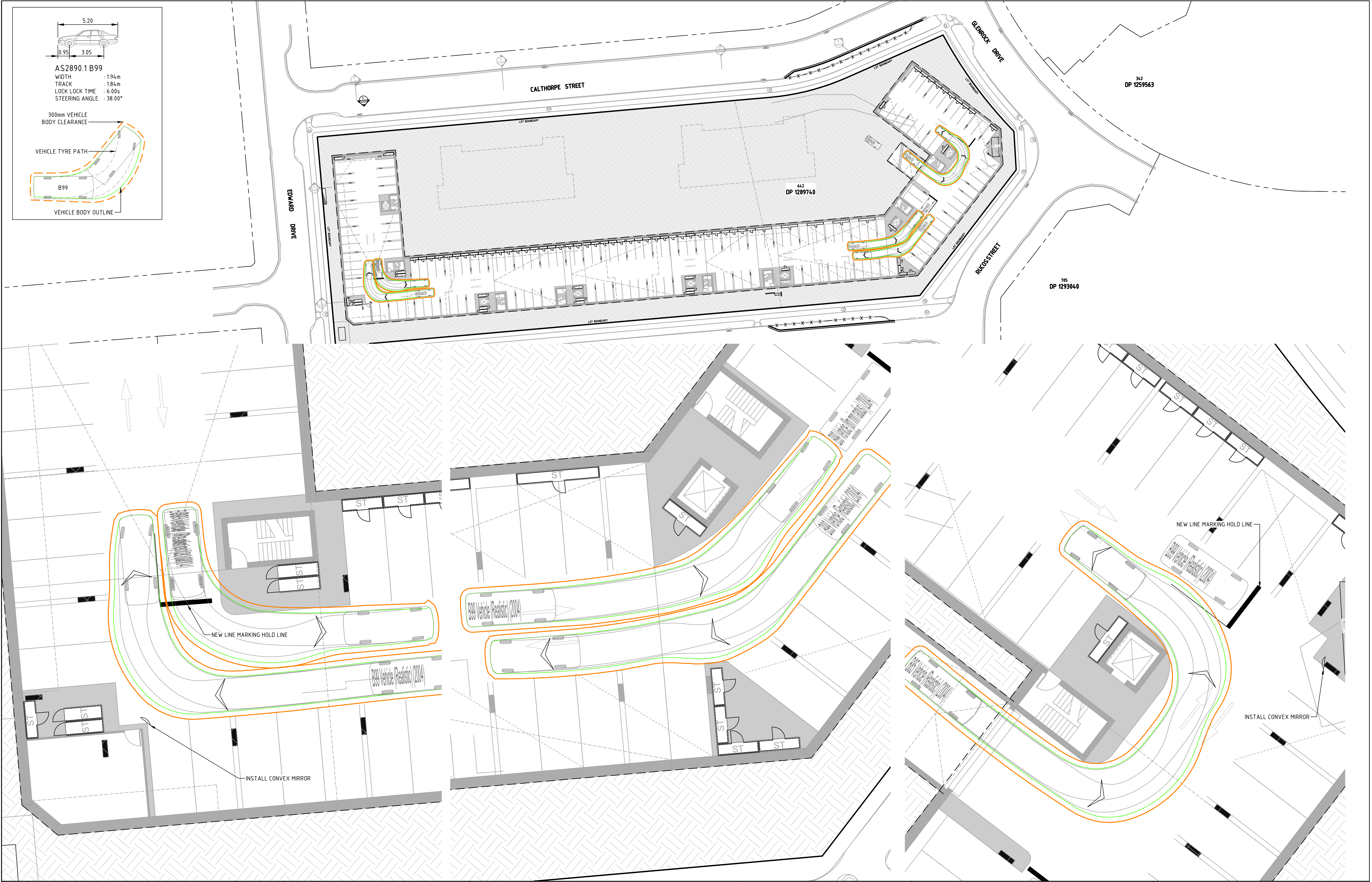

A	FOR DEVELOPMENT APPROVAL	26.07.2024	DM
Rev	Description	Date	Drawn By

Scales

057.51012.5m

1:250 @ A1

North

DO NOT SCALE OFF DRAWINGS. VERIFY ALL DIMENSIONS ON SITE PRIOR TO WORK.

COPYRIGHT: The contents and information contained in this document are copyright of Sellick Consultants, Use or copy of this document in whole or part without written permission constitutes an infringement of copyright.

canberra | sydney

ABN 82 634 296 629

Client Logo

NOT FOR CONSTRUCTION			
Original Size	A1	Drawn By	DM
Date Plotted	29-Jul-24	Designed By	LT
Coordinate System	STROMLO GRID	Approved	AM
Height Datum	AHD	Approved Signature	
Drafting Check DA			
Design Check			
Approved Date			

Project Name and Location					
MIXED USE DEVELOPMENT					
GOOGONG					
Drawing Title					
VEHICLE TURNING PATHS PLAN					
SHEET 4					
Project Number	Type	Discipline	Sub-Discipline	Drg No.	Rev
230790	DRG	CIV	TP	2204	A

File Name: P:\2023\230790_Lot-642-Googong\04_CAD\4_2_Drawings\CIV\230790-drg-civ-2301-wm.dwg

NOTES

- WASTE ENCLOSURE FLOORS AND 2.4m x 2.4m HOPPER PADS ARE TO BE CONSTRUCTED OF FORMED CONCRETE WITH SLIP RESISTANCE FINISH.
- EDGES OF DOORWAYS OR CORNERS OF WALLS WITHIN THE WASTE ENCLOSURE ARE TO BE FITTED WITH GALVANISED STEEL ANGLES.
- FLOOR, WALLS AND CEILINGS MUST BE CONSTRUCTED OF SOLID MATERIAL. IE NOT RENDERED OR PLASTERED.
- FINISHES ARE TO BE SMOOTH AND IMPERVIOUS.
- PROTECTIVE STEEL SHEETING MUST BE INSTALLED FLUSH ON THE INSIDE OF ENCLOSURE WALLS.
- A BUMP RAIL, CONSTRUCTED OF GALVANISED STEEL OR OTHER DURABLE IMPERVIOUS MATERIAL MUST BE INSTALLED AROUND THE WALLS. BUMP RAILS TO BE AT A HEIGHT BETWEEN 0.9m AND 1.3m. THE BUMP RAIL MUST BE A MINIMUM 50mm CLEAR OF WALLS.
- DOORWAYS FOR HOPPER TRANSFER MUST HAVE A MINIMUM CLEAR WIDTH OF 2.4m, UNLESS OTHERWISE APPROVED BY ACT NOWASTE.
- DOORWAYS FOR HOPPER TRANSFER MUST HAVE A MINIMUM CLEAR HEIGHT OF 2.4m, UNLESS OTHERWISE APPROVED BY ACT NOWASTE.
- WHERE BUILDING OCCUPANTS ARE REQUIRED TO HAVE ACCESS, A SEPARATE ACCESSIBLE DOORWAY (0.85m WIDE) MUST BE PROVIDED WITH AN ACCESSIBLE PATH OF TRAVEL TO DEPOSIT WASTE AND RECYCLING IN THE BINS.
- RAINWATER MUST BE PREVENTED FROM ENTERING THE SEWERAGE SYSTEM BY PROVIDING ROOFING OR PROTECTION AGAINST WIND BLOWN RAIN AND DIVERTING RUNOFF.
- DOORS TO THE WASTE ENCLOSURE MUST BE DURABLE AND SELF-CLOSING.
- WHERE ROLLER DOORS ARE USED THEY MUST HAVE SIGNAGE STATING, "DOOR TO BE KEPT SHUT WHEN NOT IN USE".
- AN INTERNAL LIGHT SWITCH MUST BE LOCATED ADJACENT TO THE ENTRY DOOR.
- SUITABLE PROTECTION MUST BE PROVIDED TO ALL FITTINGS AND SERVICES WITHIN THE WASTE ROOM OR AROUND THE DESIGNATED HOPPER PAD TO PREVENT DAMAGE FROM BIN MOVEMENTS.
- DOORWAYS ON ENCLOSURES HOUSING HOPPERS MUST BE SUFFICIENTLY WIDE TO ALLOW FOR EASY ACCESS OF HOPPERS AND MUST BE FITTED WITH GALVANISED STEEL ANGLES ON THE INSIDE AND OUTSIDE TO PROTECT THEM AGAINST DAMAGE CAUSED BY HOPPERS STRIKING DOORS WHEN THEY ARE BEING RELOCATED. BOLLARDS MAY BE USED INSTEAD OF STEEL ANGLES AND IN SITUATIONS TO PROTECT ROLLER DOOR RAILS.
- ALL DRAINS WITHIN WASTE ENCLOSURE ARE TO BE DESIGNED TO PREVENT THE CATCHING OF BIN WHEELS. SLOTTED GRATES ARE NOT PERMITTED.
- GRADES INSIDE THE WASTE ENCLOSURE ARE NOT TO EXCEED 2% (1:50) AND FALL TOWARDS AN INTERNAL FLOOR WASTE WITH SILT TRAP (IF PRESENT) OR OTHERWISE THE DOORWAY.
- GRADES OF THE 2.4m x 2.4m HOPPER COLLECTION PAD AND THE PATH OF TRAVEL BETWEEN THE HOPPER PAD AND WASTE ROOM ARE NOT TO EXCEED 3% (1:33).
- GRADES OF THE PATH OF TRAVEL FOR MGB'S BETWEEN THE COLLECTION PAD AND WASTE ROOM ARE NOT TO EXCEED 10% (1:10).
- FINISHED FLOOR LEVEL BETWEEN HOPPER PAD AND WASTE ROOM MUST BE FLUSH WITH NO LIP.
- ALL COMMERCIAL ENCLOSURES TO INCLUDE ROOF, FLOOR WASTE AND WATER SUPPLY.
- ALL RESIDENTIAL ENCLOSURES WITHIN THE FABRIC OF THE BUILDING TO INCLUDE FLOOR WASTE AND WATER SUPPLY.
- WHERE A WATER SUPPLY IS REQUIRED, A COLD TAP MUST BE PROVIDED EITHER IN OR ADJACENT TO THE ENCLOSURE SO THAT THE WASTE CONTAINER CAN BE CLEARED. A PROTECTIVE STEEL GUARD RAIL OR BOLLARD AROUND THE TAP MUST BE PROVIDED TO PREVENT DAMAGE WHEN BINS ARE BEING MOVED.
- SEPARATE SEWER AND WATER CONNECTIONS ARE TO BE PROVIDED TO THE SEPARATE WASTE ENCLOSURES.
- ALL WASTE/RECYCLING/GREEN WASTE ROTATION OF BINS WITHIN SITE BETWEEN THE SATELLITE ENCLOSURES AND THE MAIN ENCLOSURE IS TO BE UNDERTAKEN BY BODY CORPORATE.
- HOPPERS TO BE FITTED WITH APPROPRIATE CONNECTIONS FOR TUG DEVICE. FITTING TO ENSURE THAT THEY ARE COMPATIBLE AND DO NOT INTERFERE WITH ACT NOWASTE COLLECTION.
- RESIDENTIAL WASTE AND RECYCLING CAPACITY HAS BEEN PROVIDED IN ACCORDANCE WITH THE 2019 DCC.
- ALL BINS PROVIDED FOR THE DEVELOPMENT ARE TO COMPLY WITH AUSTRALIAN STANDARD 4123.
- ALL BINS ARE TO BE CLEARLY IDENTIFIED TO PREVENT WASTE AND RECYCLING BEING CONTAMINATED.
- WASTE STRATEGY ASSESSED AGAINST 'WASTE AND RECYCLE MANAGEMENT CODE (2019)'.

WASTE MANAGEMENT OPERATIONS

- RESIDENT:
 - TRANSFER WASTE DIRECTLY INTO HOPPERS IN EITHER WASTE ENCLOSURE
- BUILDING MANAGER:
 - TRANSFER FULL & EMPTY HOPPERS BETWEEN WASTE ENCLOSURES A & B AND WASTE ENCLOSURES C & D
- WASTE COLLECTION CONTRACTOR:
 - COLLECT WASTE FROM ENCLOSURES A & B, RETURNING EMPTIED HOPPERS INTO EACH ENCLOSURE.

COMMERCIAL WASTE REQUIREMENTS (BUILDING A)

RESIDENTIAL							
NO. OF BEDS	NO. OF UNITS	RECYCLING/UNIT /WEEK (LITRES)	TOTAL RECYCLING (m³)	BIN SIZE	NO. OF COLLECTIONS PER WEEK	COMPACTION	WEEKLY CAPACITY (m³)
4+	0	14.0	0.00	1 x 1.1m³	1	1	1.10
3	0	120	0.00				
2	4	120	0.48				
1+S	0	120	0.00				
1	0	120	0.00				
TOTAL	4		0.48				

COMMERCIAL RECYCLING REQUIREMENTS (BUILDING A)

RESIDENTIAL							
NO. OF BEDS	NO. OF UNITS	RECYCLING/UNIT /WEEK (LITRES)	TOTAL RECYCLING (m³)	BIN SIZE	NO. OF COLLECTIONS PER WEEK	COMPACTION	WEEKLY CAPACITY (m³)
4+	0	14.0	0.00	1 x 1.1m³	1	1	1.10
3	0	120	0.00				
2	4	120	0.48				
1+S	0	120	0.00				
1	0	120	0.00				
TOTAL	4		0.48				

WASTE REQUIREMENTS

RESIDENTIAL							
NO. OF BEDS	NO. OF UNITS	WASTE/UNIT /WEEK (LITRES)	TOTAL WASTE (m³)	BIN SIZE	NO. OF COLLECTIONS PER WEEK	COMPACTION	WEEKLY CAPACITY (m³)
4+	0	14.0	0.00	18 x 1.1m³	1	1	19.80
3	28	120	3.36				
2	103	120	12.36				
1+S	12	120	1.44				
1	16	120	1.92				
TOTAL	159		19.08				

RECYCLING REQUIREMENTS

RESIDENTIAL							
NO. OF BEDS	NO. OF UNITS	RECYCLING/UNIT /WEEK (LITRES)	TOTAL RECYCLING (m³)	BIN SIZE	NO. OF COLLECTIONS PER WEEK	COMPACTION	WEEKLY CAPACITY (m³)
4+	0	14.0	0.00	18 x 1.1m³	1	1	19.80
3	28	120	3.36				
2	103	120	12.36				
1+S	12	120	1.44				
1	16	120	1.92				
TOTAL	159		19.08				

CHUTES MUST HAVE THE FOLLOWING PROPERTIES:

- CHUTES MUST BE LOCATED AND INSULATED IN A MANNER THAT REDUCES NOISE AND ODOUR IMPACT ON DWELLINGS.
- CHUTES AND ALL ANCILLARY DEVICES MUST BE CONSTRUCTED OF SMOOTH, DURABLE, IMPERVIOUS, NON-CORROSIVE AND FIRE RESISTANT MATERIAL. CHUTES AND ALL ANCILLARY DEVICES MUST BE EASY TO CLEAN AND MUST HAVE AN APPROPRIATE CLEANING SYSTEM INSTALLED.
- CHUTES MUST BE CYLINDRICAL AND MUST HAVE A MINIMUM DIAMETER OF 0.50M. THE MAIN SHAFT OF THE CHUTE MUST NOT HAVE BENDS OR SECTIONS OF REDUCED DIAMETER. HOWEVER, BENDS WILL BE GIVEN CONSIDERATION FOR REDUCING THE VELOCITY OF WASTE AND RECYCLABLES PROVIDED THEY COMPLY WITH THE MANUFACTURER'S ENGINEERING SPECIFICATIONS. INTERNAL OVERLAPS IN THE CHUTE MUST FOLLOW THE DIRECTION OF WASTE OR RECYCLABLE MATERIAL FLOW.
- THE VENTILATION AT THE TOP OF THE CHUTE MUST EXTEND ABOVE THE BUILDING ROOF LINE AND BE WEATHER PROTECTED.
- CHUTES MUST DEPOSIT WASTE AND RECYCLABLES DIRECTLY INTO THE BIN OR RORO COMPACTOR LOCATED WITHIN A WASTE CHUTE ROOM TO PREVENT WASTE SPILLAGE AND OVERFLOW. THE ARRANGEMENTS AT THE DISCHARGE POINT OF THE CHUTE CAN BE DESIGNED TO OPTIMISE THE OPERATION WITHIN THE WASTE AND RECYCLING STORAGE FACILITY.
- IF BINS OR HOPPERS ARE USED AT THE DISCHARGE POINT OF THE CHUTES, TWO ADDITIONAL BINS/HOPPERS EACH FOR BOTH WASTE AND RECYCLING IS RECOMMENDED. HOWEVER, AT LEAST ONE ADDITIONAL BIN/HOPPER EACH FOR BOTH WASTE AND RECYCLING IS MANDATORY.
- TO AVOID CROSS-CONTAMINATION BETWEEN WASTE AND RECYCLABLES, BINS/HOPPERS AT THE DISCHARGE POINT OF THE RECYCLING CHUTE MUST BE CLEAN OF ANY GENERAL WASTE. TERRITORY-PROVIDED BINS ARE NOT TO BE USED AT THE DISCHARGE POINT OF THE CHUTE. THE DEVELOPER MUST: PROVIDE SUITABLE BINS FOR USE AT THE DISCHARGE POINT OF THE CHUTE, AND BINS ARE TO BE EMPTIED INTO THE TERRITORY-PROVIDED WASTE HOPPERS, OR PROVIDE BINS THAT ARE SUITABLE FOR SERVICING BY THE WASTE TRANSPORTER AND THAT COMPLY WITH AUSTRALIAN STANDARD AS 4123.
- A CUT-OFF DEVICE MUST BE LOCATED AT OR NEAR THE BASE OF THE CHUTE SO THAT THE BOTTOM OF THE CHUTE CAN BE CLOSED WHEN THE BIN OR COMPACTING DEVICE AT THE BOTTOM OF THE CHUTE IS WITHDRAWN OR BEING REPLACED.
- WASTE AND RECYCLING CHUTE INTAKE DOORS ON EACH RESIDENTIAL FLOOR AND BIN CHUTE DOORS AT THE TERMINATION OF THE CHUTE MUST BE FITTED WITH DOOR CLOSERS AND HAVE AN EFFECTIVE SELF-SEALING SYSTEM. THE TERMINATION OF CHUTES INTO MGBS OR HOPPERS MUST HAVE SKIRTING, OR AN EQUIVALENT SYSTEM, TO PREVENT ANY MATERIAL LEAVING THE BIN ON IMPACT. WHERE CHUTE SYSTEMS ARE INSTALLED, MGBS OR HOPPERS ARE REQUIRED TO HAVE REINFORCED BASES TO MAINTAIN THE LIFESPAN OF BINS.

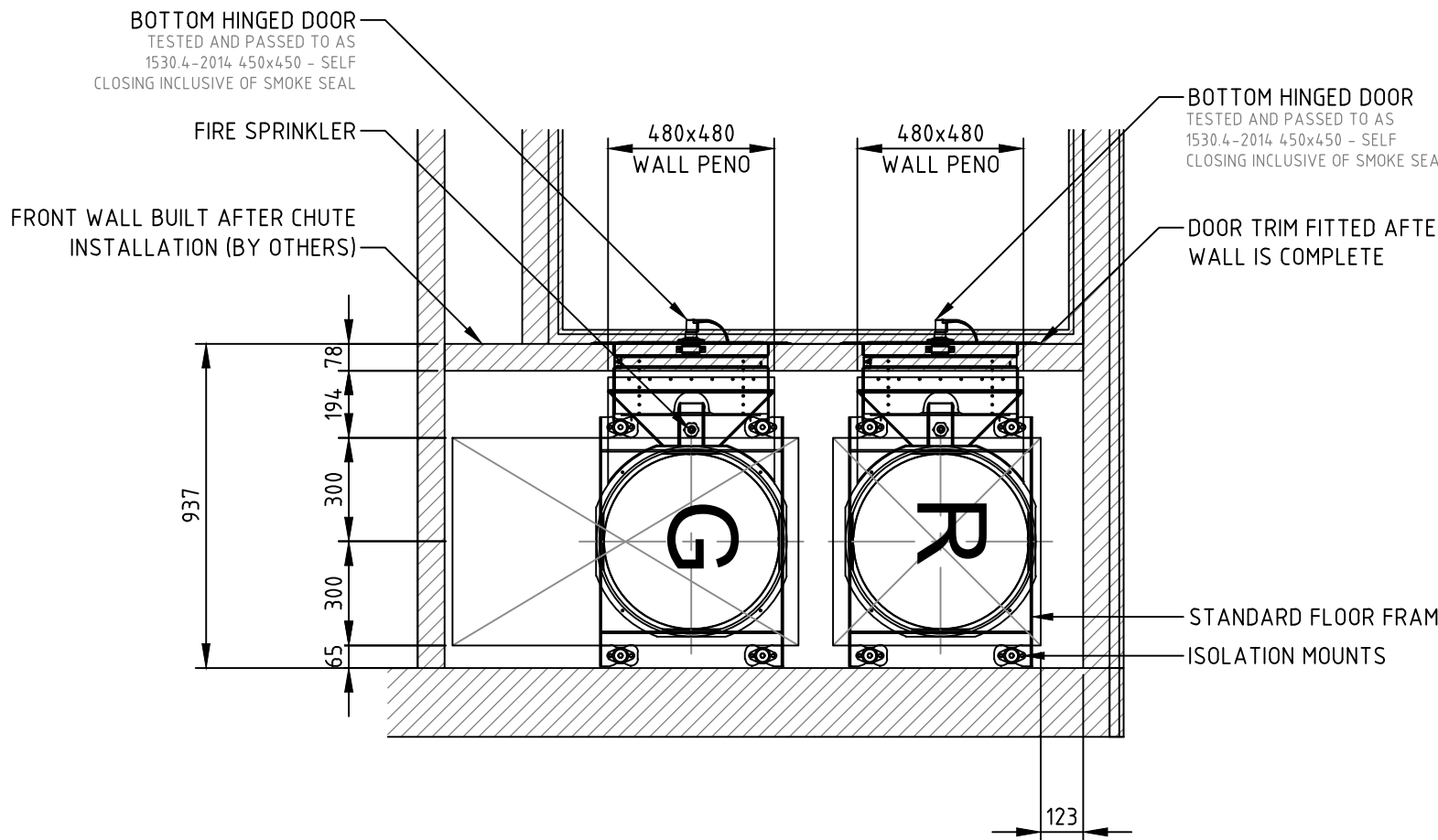

TYPICAL CHUTE DETAIL

N.T.S.

F	COUNCIL COMMENTS	26.07.2024	DM
E	FOR DEVELOPMENT APPROVAL	03.07.2024	DM
D	FOR DEVELOPMENT APPROVAL	01.07.2024	DM
C	FOR DEVELOPMENT APPROVAL	18.06.2024	DM
B	FOR DEVELOPMENT APPROVAL	17.06.2024	DM
A	FOR DEVELOPMENT APPROVAL	24.11.2023	DM
Rev	Description	Date	Drawn By

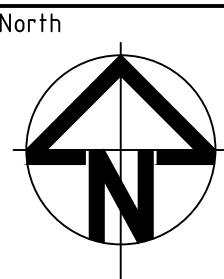
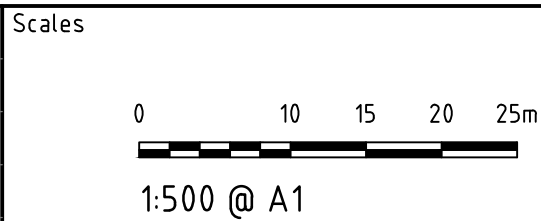

DO NOT SCALE OFF DRAWINGS. VERIFY ALL DIMENSIONS ON SITE PRIOR TO WORK.
COPYRIGHT: The contents and information contained in this document are copyright of Sellick Consultants, Use or copy of this document in whole or part without written permission constitutes an infringement of copyright.



Client Logo



Status			
NOT FOR CONSTRUCTION			
Original Size	A1	Drawn By	DM
Date Plotted	26-Jul-24	Designed By	LT
Coordinate System	STROMLO GRID	Approved	AM
Height Datum	AHD	Approved Signature	
Drafting Check	DA	Design Check	
Approved Date			

Project Name and Location					
MIXED USE DEVELOPMENT					
GOOGONG					
Drawing Title					
WASTE MANAGEMENT PLAN					
Project Number	Type	Discipline	Sub-Discipline	Drg No.	Rev
230790	DRG	CIV	WM	2301	F



F	COUNCIL COMMENTS	26.07.2024	DM	<div>Scales<div><div><div>0</div><div>2</div><div>3</div><div>4</div><div>5m</div></div><div>1:100 @ A1</div></div></div> <div>North<div></div></div> <div>DO NOT SCALE OFF DRAWINGS. VERIFY ALL DIMENSIONS ON SITE PRIOR TO WORK. COPYRIGHT: The contents and information contained in this document are copyright of Sellick Consultants. Use or copy of this document in whole or part without written permission constitutes an infringement of copyright.</div>	<div><div><div>canberra sydney</div><div>ABN 82 634 296 629</div></div></div>	<div>Client Logo<div></div></div>	<div>Status<div>NOT FOR CONSTRUCTION</div><table><tr><td>Original Size</td><td>A1</td><td>Drawn By</td><td>DM</td><td>Drafting Check</td><td>DA</td></tr><tr><td>Date Plotted</td><td>26-Jul-24</td><td>Designed By</td><td>LT</td><td colspan="2">Design Check</td></tr><tr><td>Coordinate System</td><td>STROMLO GRID</td><td>Approved</td><td>AM</td><td colspan="2">Approved Date</td></tr><tr><td>Height Datum</td><td>AHD</td><td colspan="4">Approved Signature</td></tr></table></div>	Original Size	A1	Drawn By	DM	Drafting Check	DA	Date Plotted	26-Jul-24	Designed By	LT	Design Check		Coordinate System	STROMLO GRID	Approved	AM	Approved Date		Height Datum	AHD	Approved Signature				<div>Project Name and Location<div>MIXED USE DEVELOPMENT</div><div>GOOGONG</div></div> <div>Drawing Title<div>WASTE MANAGEMENT PLAN</div></div> <table><tr><td>Project Number</td><td>Type</td><td>Discipline</td><td>Sub-Discipline</td><td>Drg No.</td><td>Rev</td></tr><tr><td>230790</td><td>DRG</td><td>CIV</td><td>WM</td><td>2302</td><td>F</td></tr></table>						Project Number	Type	Discipline	Sub-Discipline	Drg No.	Rev	230790	DRG	CIV	WM	2302	F
Original Size	A1	Drawn By	DM					Drafting Check	DA																																								
Date Plotted	26-Jul-24	Designed By	LT					Design Check																																									
Coordinate System	STROMLO GRID	Approved	AM					Approved Date																																									
Height Datum	AHD	Approved Signature																																															
Project Number	Type	Discipline	Sub-Discipline					Drg No.	Rev																																								
230790	DRG	CIV	WM	2302	F																																												
E	FOR DEVELOPMENT APPROVAL	03.07.2024	DM																																														
D	FOR DEVELOPMENT APPROVAL	01.07.2024	DM																																														
C	FOR DEVELOPMENT APPROVAL	18.06.2024	DM																																														
B	FOR DEVELOPMENT APPROVAL	17.06.2024	DM																																														
A	FOR DEVELOPMENT APPROVAL	24.11.2023	DM																																														
Rev	Description	Date	Drawn By																																														



WASTE TRANSFER STATION 'C'

[illegible]

File Name: P:\2023\230790_Lot-642-Googong\04_CAD\4.2_Drawings\CIV\230790-drg-civ-2305-wm.dwg



- NOTES**
1. WASTE ENCLOSURE FLOORS AND HOPPER PADS ARE TO BE CONSTRUCTED OF FORMED CONCRETE WITH SLIP RESISTANCE FINISH.
 2. EDGES OF DOORWAYS OR CORNERS OF WALLS WITHIN THE WASTE ENCLOSURE ARE TO BE FITTED WITH GALVANISED STEEL ANGLES.
 3. PROTECTIVE STEEL SHEETING MUST BE INSTALLED FLUSH ON THE INSIDE OF ENCLOSURE WALLS. DOORWAYS FOR HOPPER TRANSFER MUST HAVE A MINIMUM CLEAR WIDTH OF 2.4M, UNLESS OTHERWISE APPROVED BY ACT NOWASTE.
 4. DOORWAYS FOR HOPPER TRANSFER MUST HAVE A MINIMUM CLEAR HEIGHT OF 2.4M, UNLESS OTHERWISE APPROVED BY ACT NOWASTE.
 5. DOORS TO THE WASTE ENCLOSURE MUST BE DURABLE AND SELF-CLOSING.
 6. WHERE ROLLER DOORS ARE USED THEY MUST HAVE SIGNAGE STATING, "DOOR TO BE KEPT SHUT WHEN NOT IN USE".
 7. SUITABLE PROTECTION MUST BE PROVIDED TO ALL FITTINGS OR SERVICES WITHIN THE WASTE ROOM OR AROUND THE DESIGNATED HOPPER PAD TO PREVENT DAMAGE FROM BIN MOVEMENTS. RAILS FOR ROLLER DOORS MUST BE SET INTO THE WALL OR PROTECTED BY BOLLARDS TO PREVENT THEM BEING DAMAGED.
 8. ALL DRAINS WITHIN WASTE ENCLOSURE ARE TO BE DESIGNED TO PREVENT THE CATCHING OF BIN WHEELS. SLOTTED GRATES ARE NOT PERMITTED.
 9. GRADES INSIDE THE WASTE ENCLOSURE ARE NOT TO EXCEED 2% (1:50) AND FALL TOWARDS AN INTERNAL FLOOR WASTE WITH SILT TRAP (IF PRESENT) OR OTHERWISE THE DOORWAY.
 10. GRADES OF THE HOPPER COLLECTION PAD AND THE PATH OF TRAVEL BETWEEN THE HOPPER PAD AND WASTE ROOM ARE NOT TO EXCEED 3% (1:33).
 11. GRADES OF THE PATH OF TRAVEL FOR MGB'S BETWEEN THE COLLECTION PAD AND WASTE ROOM ARE NOT TO EXCEED 10% (1:10).
 12. FINISHED FLOOR LEVEL BETWEEN HOPPER PAD AND WASTE ROOM MUST BE FLUSH WITH NO LIP.
 13. ALL COMMERCIAL ENCLOSURES TO INCLUDE ROOF, FLOOR WASTE AND WATER SUPPLY.
 14. ALL RESIDENTIAL ENCLOSURES WITHIN THE FABRIC OF THE BUILDING TO INCLUDE FLOOR WASTE AND WATER SUPPLY.
 15. ALL BINS PROVIDED FOR THE DEVELOPMENT ARE TO COMPLY WITH AUSTRALIAN STANDARD 4123.
 16. WASTE STRATEGY ASSESSED AGAINST 'WASTE AND RECYCLE MANAGEMENT CODE (2019)'.

				Scales		North						Status		Project Name and Location					
				0 10 15 20 25m		N						NOT FOR CONSTRUCTION		MIXED USE DEVELOPMENT					
				1:500 @ A1								Original Size A1		Drawn By DM		Drafting Check DA		GOOGONG	
B COUNCIL COMMENTS				26.07.2024		DM						Date Plotted 26-Jul-24		Designed By LT		Design Check		Drawing Title	
A FOR DEVELOPMENT APPROVAL				24.11.2023		DM						Coordinate System STROMLO GRID		Approved AM		Approved Date		WASTE MANAGEMENT PLAN	
Rev Description				Date		Drawn By						Height Datum AHD		Approved Signature				Project Number	
																		230790	
																		Type DRG	
																		Discipline CIV	
																		Sub-Discipline WM	
																		Drg No. 2305	
																		Rev B	